

Features

- Load Life : 105 °C 1000~2000 hours.
- For high density mounting.
- Low impedance at 100kHz.



Specifications

Item	Performance Characteristics							
Operating Temperature Range	-40°C to +105°C							
Rated Working Voltage	6.3~50VDC							
Capacitance Tolerance	±20%(at 120Hz, 20°C)							
Surge Voltage(V)(20°C)	WV	6.3	10	16	25	35	50	
	SV	8	13	20	32	44	63	
Leakage Current (at 20°C)	I=0.01CV or 3(μA) whichever is greater (after 2 minutes) Where , C=rated capacitance in μF. V=rated DC working voltage in V							
Dissipation Factor (Tan δ at 120Hz, 20 °C)	Rated Voltage (V)		6.3	10	16	25	35	50
	Tan δ (max)	φ4~φ6.3	0.24	0.20	0.16	0.14	0.12	0.12
φ8~φ10		0.28	0.24	0.20	0.16	0.14	0.14	
Add 0.02 per 1000 μF for more than 1000 μF								
Low Temperature Characteristics (at 120Hz)	Impedance ratio at 120Hz							
	Rated Voltage (V)		6.3	10	16	25	35	50
	Impedance Ratio	Z(-25 °C)/Z(+20 °C)		3	2	2	2	2
Z(-40 °C)/Z(+20 °C)		5	4	4	3	3	3	
Load Life Test	*After hours (φD ≤ 6.3mm 1000 hours, φD ≥ 8mm 2000 hours) application of WV at +105°C the capacitor shall meet the following limits.							
	Capacitance Change	≤ ±25% of initial value						
	Dissipation Factor	Less than 200% of specified value						
	Leakage Current	With specified value						
Shelf Life Test	Without Voltage Test time:1000 hrs; other items are the same as those for the load life test.							
Standards	Satisfies Characteristic W of JIS C5141							

Diagram of Dimensions: (Unit: mm)

Fig 1

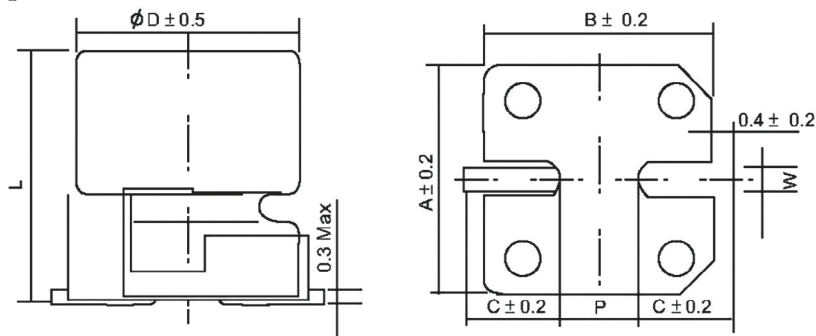

φD	L	A	B	C	W	P	Fig No.
4	5.4±0.3	4.3	4.3	2.0	0.5~0.8	1.0	1
5	5.4±0.3	5.3	5.3	2.3	0.5~0.8	1.5	1
6.3	5.4±0.3	6.6	6.6	2.7	0.5~0.8	2.0	1
6.3	7.7±0.3	6.6	6.6	2.7	0.5~0.8	2.0	1
8	10.2±0.3	8.3	8.3	3.4	0.7~1.1	3.1	1
10	10.2±0.3	10.3	10.3	3.5	0.7~1.1	4.6	1

» Multiplier For Ripple Current VS, Frequency

V.DC(V)	Freq.(Hz)	50(60)	120	1K	10K	100K
6.3~50		0.55	0.65	0.80	0.90	1.00

» Case Size

W.V.	Cap (μF)	Size (mm) ϕDxL	Imp. (Ω) 100KHz, 20°C	R.C. (mA,rms) (max)100KHz, 105°C
6.3	22	4x5.7	1.35	80
	33	4x5.7	1.35	80
	47	5x5.7	0.8	150
	100	6.3x5.7	0.44	230
	150	6.3x5.7	0.44	230
	200	6.3x7.7	0.36	280
	330	8x6.5	0.36	280
		8x10	0.17	450
	470	8x10	0.17	450
		10x7.7	0.17	450
	680	8x10	0.17	450
		10x7.7	0.17	450
	1000	8x10	0.17	450
	1500	10x10	0.09	670
	2200	12.5x13.5	0.07	820
3300	12.5x16	0.06	950	
4700	16x16.5	0.054	1260	
6800	18x16.5	0.048	1500	
	16x21.5	0.038	1630	
8200	18x16.5	0.048	1500	
	16x21.5	0.038	1630	
10	22	4x5.7	1.35	80
	33	5x5.7	0.44	150
	47	6.3x5.7	0.44	230
	100	6.3x5.7	0.44	230
	150	6.3x5.7	0.44	230
	220	6.3x7.7	0.36	280
		8x6.5	0.36	280
	330	8x10	0.17	450
		10x7.7	0.17	450
	470	8x10	0.17	450
		10x7.7	0.17	450
	680	10x10	0.09	670
	1000	10x10	0.09	670
	1500	12.5x13.5	0.07	820
	2200	12.5x16	0.06	950
3300	16x16.5	0.054	1260	
4700	16x16.5	0.054	1260	
6800	18x16.5	0.048	1500	
	16x21.5	0.038	1630	
8200	18x21.5	0.038	1750	

W.V.	Cap (μF)	Size (mm) φDxL	Imp. (Ω) 100KHz, 20°C	R.C. (mA,rms) (max)100KHz,105°C
16	10	4x5.7	1.35	80
	22	5x5.7	0.8	150
	33	6.3x5.7	0.44	230
	47	6.3x5.7	0.44	230
	100	6.3x5.7	0.44	230
	150	6.3x7.7	0.36	280
		8x6.5	0.36	280
	220	6.3x7.7	0.36	280
	330	8x10	0.17	450
		10x.7	0.17	450
	470	8x10	0.17	450
		10x10	0.09	670
	680	10x10	0.09	670
	1000	12.5x13.5	0.07	820
	1500	12.5x16	0.06	950
	2200	16x16.5	0.054	1260
3300	16x16.5	0.054	1260	
	16x21.5	0.038	1630	
4700	18x16.5	0.048	1500	
	16x21.5	0.038	1630	
25	10	4x5.7	1.35	80
	22	5x5.7	0.8	150
	33	6.3x5.7	0.44	230
	47	6.3x5.7	0.44	230
	100	6.3x7.7	0.36	280
	150	8x6.5	0.36	280
		8x10	0.17	450
	220	8x10	0.17	450
	330	10x7.7	0.17	450
		8x10	0.17	450
	470	10x10	0.09	670
	680	12.5x13.5	0.07	820
	1000	12.5x16	0.06	950
	1500	16x16.5	0.054	1260
	2200	16x16.5	0.054	1260
	3300	18x16.5	0.048	1500
16x21.5		0.038	1630	
18x21.5	0.038	1750		
35	4.7	4x5.7	1.35	80
	10	5x5.7	0.8	150
	22	6.3x5.7	0.44	230
	33	6.3x5.7	0.44	230
	47	6.3x5.7	0.44	230
	68	8x6.5	0.36	280
	100	8x10	0.17	450
	150	8x10	0.17	450
		10x7.7	0.17	450
	220	10x10	0.09	670
	330	10x10	0.09	670
		12.5x13.5	0.07	820
	470	12.5x16	0.06	950
	680	12.5x16	0.06	950
	1000	16x16.5	0.054	950
	1500	18x16.5	0.048	1500
16x21.5		0.038	1630	
2200	18x21.5	0.038	1750	

W.V.	Cap (μF)	Size (mm) φDxL	Imp. (Ω) 100KHz , 20°C	R.C. (mA,rms) (max)100KHz,105°C	
50	1	4x5.7	2.9	60	
	2.2	4x5.7	2.9	60	
	3.3	4x5.7	2.9	60	
	4.7	5x5.7	1.52	85	
	10	6.3x5.7	0.88	165	
	22	6.3x5.7	0.88	165	
	33	6.3x7.7	0.68	185	
	47	6.3x7.7	0.68	185	
	68	8x6.5	0.68	185	
	100	8x10	0.34	369	
	150	8x10	0.34	369	
	220	10x10	0.18	553	
	330	10x10	0.18	553	
	470	12.5x13.5	0.12	650	
	680	12.5x13.5	0.12	650	
63	4.7	5x5.7	1.9	70	
	10	6.3x5.7	1.2	130	
	22	6.3x7.7	0.9	150	
	33	8x10	0.5	280	
	47	8x10	0.5	280	
	100	10x10	0.25	450	
	150	12.5x13.5	0.15	700	
	220	12.5x13.5	0.15	700	
	330	16x16.5	0.082	900	
	470	16x16.5	0.082	900	
	680	18x16.5	0.08	1150	
	1000	16x21.5	0.08	1150	
	1500	18x21.5	0.06	1250	
	80	22	8x10	1.3	130
		33	8x10	1.3	130
47		10x10	0.7	200	
100		10x10	0.7	200	
150		12.5x13.5	0.32	450	
220		12.5x16	0.26	550	
330		16x16.5	0.17	650	
470		16x21.5	0.15	900	
680		18x21.5	0.15	950	
100		22	8x10	1.3	130
	33	10x10	0.7	200	
	47	10x10	0.7	200	
	100	12.5x13.5	0.32	450	
	150	12.5x16	0.26	550	
	220	16x16.5	0.17	650	
	330	18x21.5	0.15	950	
	470	18x16.5	0.15	850	
		16x21.5	0.15	900	
		18x21.5	0.15	950	